

Bee Fold Lane, Atherton, M46 0TT
Offers Over £315,000

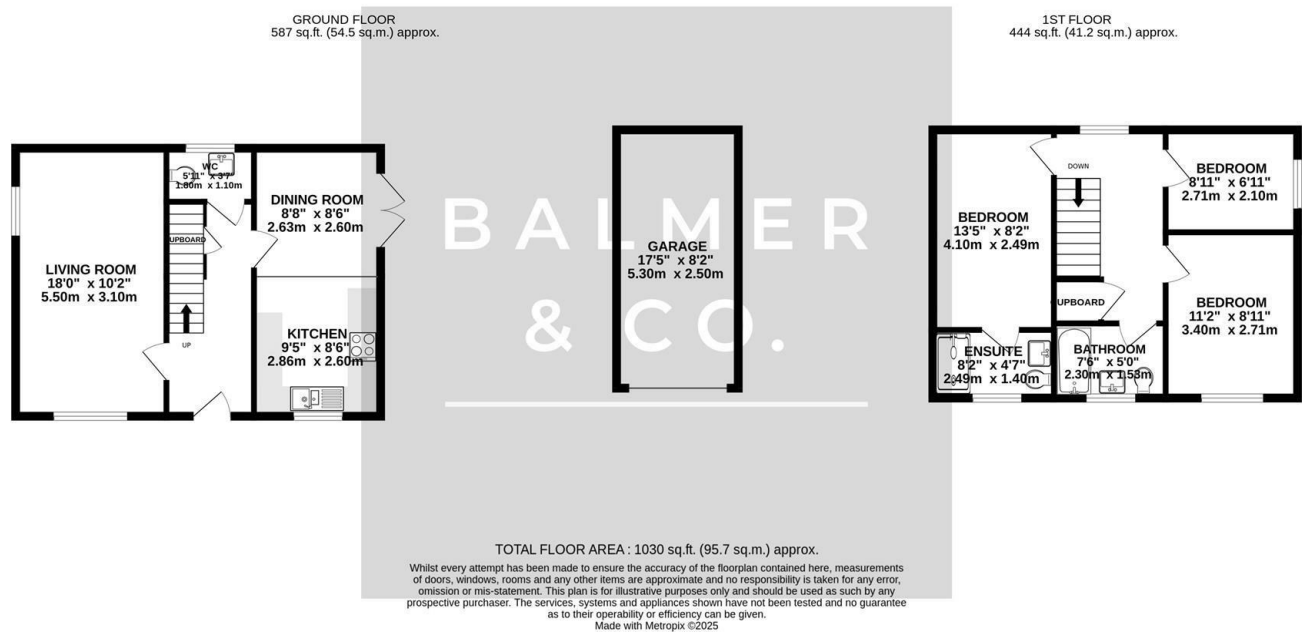

BALMER & CO in ATHERTON are delighted to offer FOR SALE this fantastic three bedroom detached family home, situated on the highly popular Bee Fold Lane development in Atherton. Immaculately presented throughout and conveniently placed within walking distance of the town centre and a range of amenities, it would be perfect for young or growing families. Briefly comprising; spacious entrance hall with w.c, living room and modern fitted kitchen/diner with integrated appliances. To the first floor is a master bedroom with ensuite shower room, a second double bedroom and a single bedroom. A three piece family bathroom suite completes the internal accommodation. Externally, there are gardens to the front and each side of the property with a detached garage and driveway. Early viewings highly recommended, all enquiries welcome.

Floor Plan



Area Map

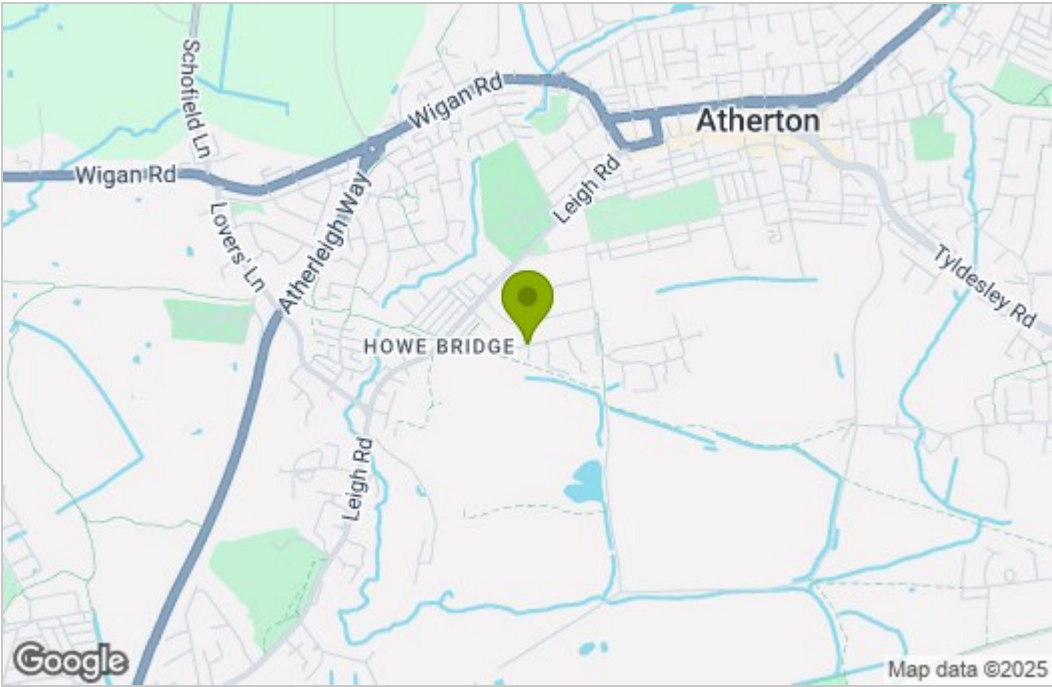

Energy Efficiency Graph

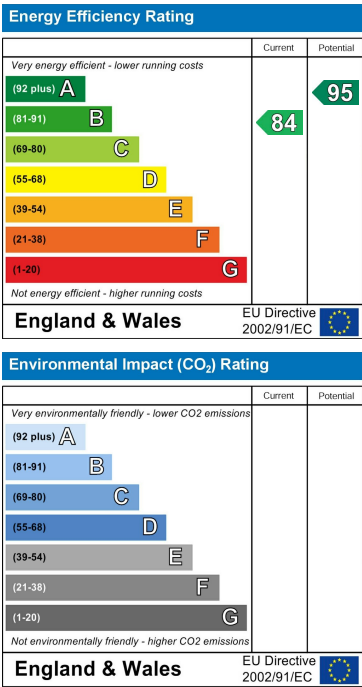

These particulars, whilst believed to be accurate are set out as a general outline only for guidance and do not constitute any part of an offer or contract. Intending purchasers should not rely on them as statements of representation of fact, but must satisfy themselves by inspection or otherwise as to their accuracy. No person in this firms employment has the authority to make or give any representation or warranty in respect of the property.